

IV.FUNCTION DESCRIPTION OF INDOOR UNIT

a.Indoor unit ringtone setting

1.Mute setting

In the standby mode of the indoor unit, press the button “” first to turn on the screen, and then press the button “” to turn off the bell and intercom, making no effects on image display.If it is required to turn on the bell and intercom, press the button “” again in the monitor “” mode.

- Disturbance-free mode will be activated after the mute function is enabled.

2.Change ringtone

In the standby mode of the indoor unit, press the button “” first to turn on the screen, and then press the button “” to activate the ringtone and enter “change ringtone” settings. The system is equipped with 25 ringtones of various lengths. The button “” is pressed once to change one ringtone. After a suitable ringtone is selected, stop pressing the button. The last ringtone will be the ringtone when the system is called by anyone.

3. Ringtone volume adjustment

In the standby mode of the indoor unit, press the button “” first to turn on the screen, It has three levels, large, medium and small. Press the button “” for two seconds each time to increase or decrease the volume progressively.

- After power-off, all ringtone settings will be restored to factory settings.

b.Instructions for doorbell operation

1.When any visitor presses the call button on the outdoor unit, the indoor unit screen will display the outdoor image in real time and the bell will ring.

2.The indoor user may press the button “” to talk with the visitor.

3.In the intercom mode, the indoor user may press the button “” to open the door.

4.In the intercom mode, the indoor user may press the button “” to finish talking or talking will finish automatically in 90 seconds.

5.If it is required to resume talking after hang-up, press the button “” first and then the button “” to talk with the visitor.

6.In the standby mode of the indoor unit, press the button “” first and then the button “” to unlock the door; the screen will be off automatically in 90 seconds or it can be powered off by pressing the button “” once.

V.ID CARD INSTRUCTIONS

a. Add user card

Under the working status , swipe " add card " , " Di " once , enter the additional user card state. When swiping a user card , " Di " once showed that the card has been successfully added . (at most add 500pcs user card) If it rings three times , it means the card is full , this card cannot be added.

To exit the add user card status , swipe the add card again , " Di " once , exit to add user card state into standby .

b.Delete user cardr

Under the working status , swipe “delete card”,enter the delete user card state.Swipe the user card you want to delete . hear a sound “Di”showed the card has been sucessfully deleted.To exit the delete user card status,swipe the delete card again,“Di”once,exit to add user card state into standby.

Delete ALL:under the working status,first swipe“delete card”.Then swipe “add card” .

Finally swipe the delete card.The operation is completed.

c.Swipe card open the door

Under the working status,close the card to the read card area,if it is an authorized user card, will hear the sound “Di”.Unlocking at the same time.If the card is illegal card,will make sounds “Di Di Di”,prompt that the card is no authorized.

d.Production Management Card

Toggle switch, flip the switch up, then turn on the power, and enter the setting mode after prompting a beep. Swipe the first card is add card, swipe second card is delete card, then turn off power,set the switch down to reset. This means that setting the management card is successful.

VI.PRODUCT INSTALLATION

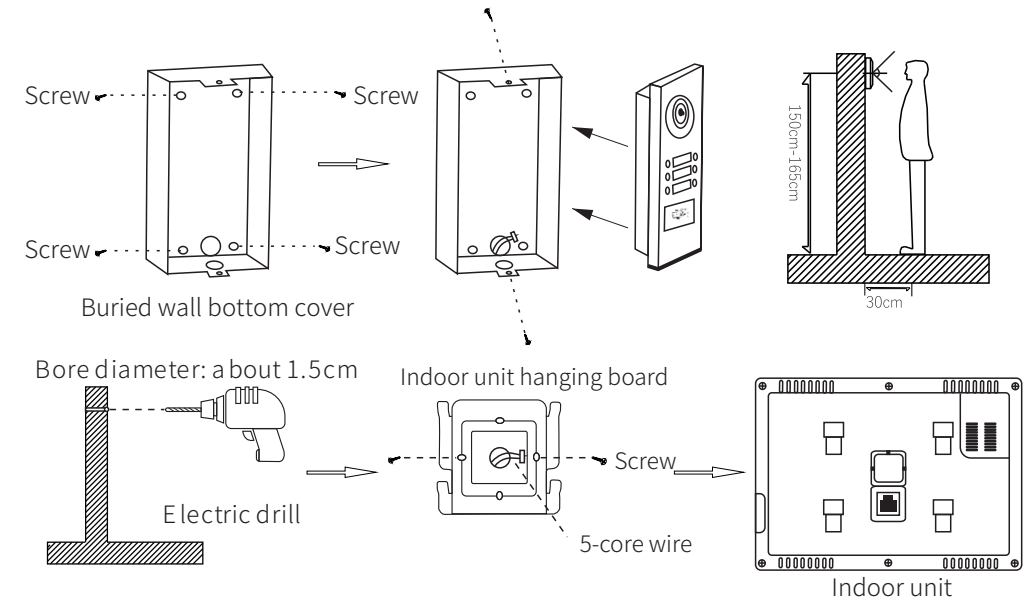

VII.PRODUCT DIAGRAM

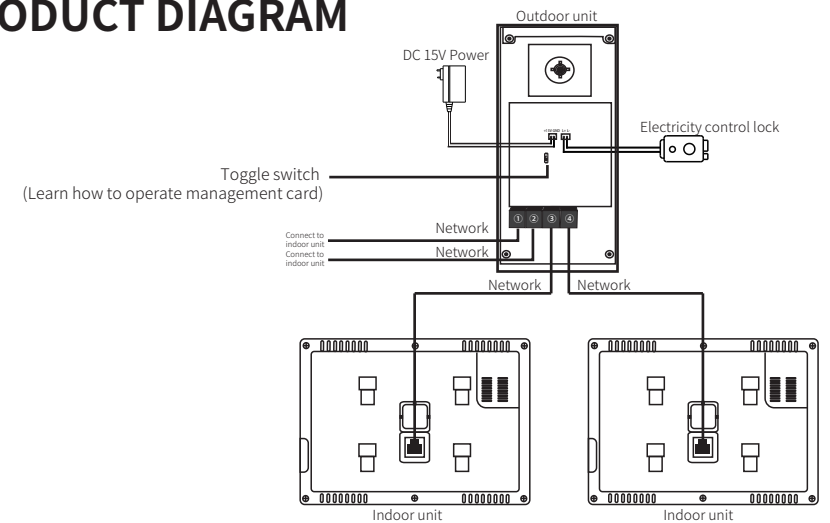

MULTI-USER DIRECT PRESS VISUAL INTERCOM DOORBELL

Installation instruction manual

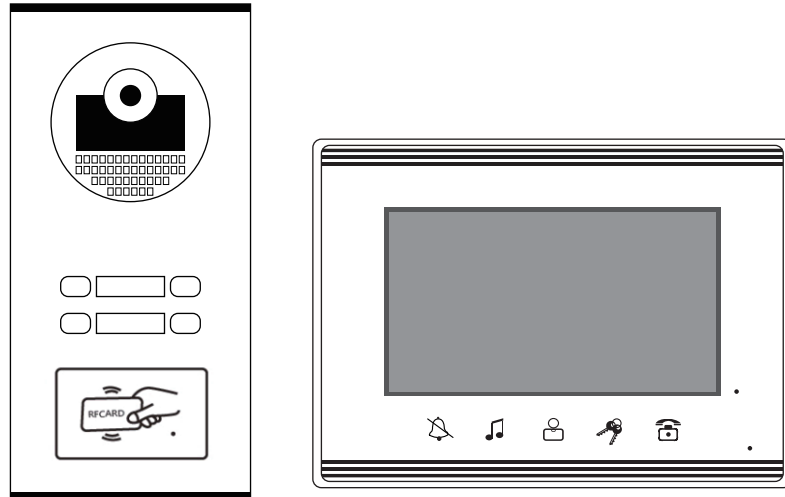

Please read the instructions carefully before using to guarantee correct and proper operation

I .PRODUCT DESCRIPTION

This product is a multi-user direct press wired visual intercom doorbell, the system consists of two parts: outdoor unit and indoor unit, using 8-core network wire, RJ45 interface connection. Outdoor unit adopts DC15V unified power supply. The longest transmission distance can reach 100 meters. Can realize call intercom, unlock, active monitoring, mute and do not disturb, outdoor unit with ID card to open the door and other functions. Suitable for family, villa, apartments, office and other places.

II .PRODUCT INTRODUCTION

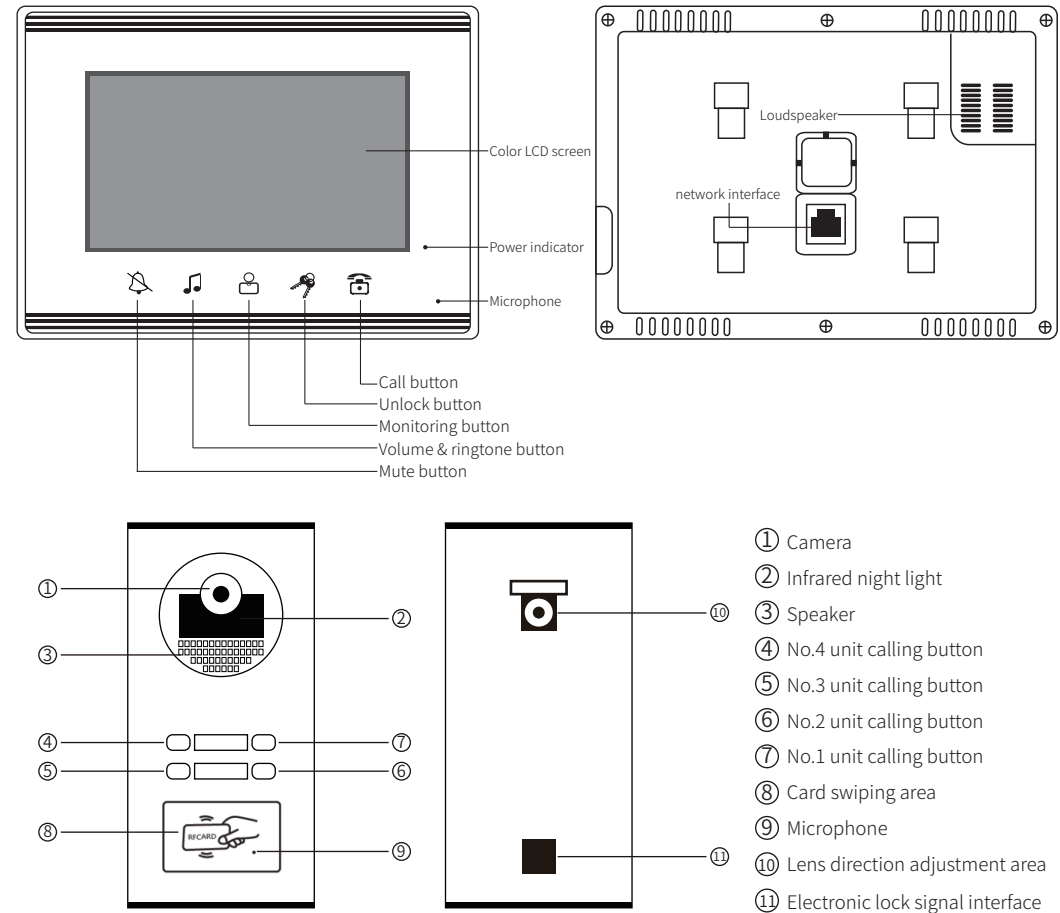

III.PARAMETERS OF INDOOR UNIT

Camera	COMS HD camera	Screen	COMS HD camera
Rain-proof grade	With rainproof cover	Resolution	With rainproof cover
Power supply	Special power adapter for power supply DC15V	Power supply	Special power adapter for power supply DC15V
Power	Standby:≤0W Working:≤10W	Power	Standby:≤0W Working:≤10W
Connect terminal	Net port	Wiring terminal	Net port
Unlocking terminal	2PX2.54	Operating temperature	2PX2.54
Working temperature	-20°C-60°C	Monitoring time	-20°C-60°C
Night vision feature	Infrared night light	Talking time	Infrared night light
Unlocking voltage	DC12V	Number of calling ringtones	DC12V